

Model TS22 Miniature Reaction Torque Transducer

- Capacities from 0.005 Nm to 20 Nm
- 5X safe overload on capacities up to 2 Nm
- Very small measuring ranges



OPTIONS

Enhanced Accuracy – 0.1% nonlinearity & hysteresis
Internal Shunt Resistor – 100% output

SPECIFICATIONS

ACCURACY – (MAX ERROR)	
Nonlinearity - %FS	+/-0.2
Hysteresis - %FS	+/-0.2
Nonrepeatability - % RO	+/-0.1
TEMPERATURE	
Effect on Zero - % RO/°C	+/-0.02
Effect on Output - %/°C	+/-0.01
Compensated Range - °C	-5 to +45
Operating Range - °C	-15 to +55
ELECTRICAL	
Output – mV/V	
0.005 Nm to 2 Nm	0.5
1 Nm to 20 Nm	1.0
Excitation Voltage – VDC	2-12
Bridge Resistance – Ohm	350
Electrical Connection	6 pin Binder
MECHANICAL	
Safe Overload - % RO	
0.005 Nm to 2 Nm	500
1 Nm to 20 Nm	200
Angular Deflection at Rated Torque -	<0.2
Cyclic Load Rating - % RO	+/-70 Peak
IP Rating	50

DIMENSIONS

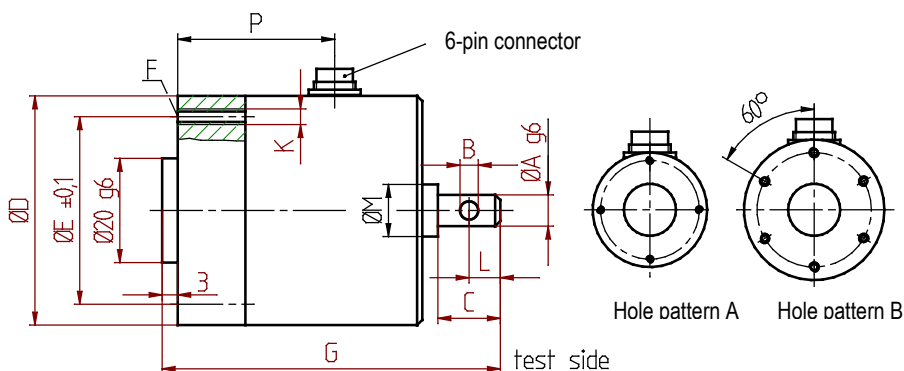

Meas. range [N·m]	A	B	C	D	E	F	G	K	L	M	P	Hole pattern
0.005, 0.01	3	-	5	44	38	4x90°	58	M 3	-	10	30	A
0.02, 0.03, 0.05, 0.1, 0.2, 0.5, 1, 2	6	2.5	12	44	38	4x90°	65	M 3	6	10	30	A
5, 10, 12, 15, 20	12	4	18	54	44	6x60°	65	M 4	8	14	28	B