

FLUSH MOUNT PRESSURE TRANSMITTER

MODEL 240/340-IM



Model 340-IM
Flush Mount Design

FEATURES:

- Flush faced sensor minimizes media plugging and damage
- Compact 1" diameter
- Rugged, all-welded stainless steel design
- No zero offset from installation
- 5X proof pressure

APPLICATIONS:

- Wastewater treatment
- Onboard vehicles
- Skidded systems
- Sludge and slurries
- Adhesives and paints
- Pump suction and discharge lines of blender and Frack trucks
- Corrosive and higher viscosity media

PRODUCT OVERVIEW:

The Model 40-IM series from GP:50 is a flush face mounted industrial pressure transmitter. It is expressly designed for higher viscosity media, particularly where such media can otherwise clog or damage traditional non-flush port sensor designs. The rugged, all-welded, Inconel design of the 40-IM series allows for greater compatibility with corrosive media. No zero offset is caused during sensor installation.

FIELD OPTIONS:

- Direct NPT or flanged process mounting
- Select electrical connectors
- 4-20 mA or 0-5Vdc output

APPROVALS:

- ATEX & IEC Hazardous approvals
- FM & CSA Pending



GP:50 MODEL 240/340-IM

DIMENSIONAL DRAWING

All dimensions are in inches (mm)

STANDARD WIRING		
PIN	MODEL 240	MODEL 340
A/1/RED	+EXC	+EXC/SIG
B/2/GRN	+SIG	N/C
C/3/WHT	N/C	N/C
D/4/BLK	-EXC/SIG	-EXC/SIG
E/5/BLU	N/C	N/C
F/6/BRN	N/C	N/C

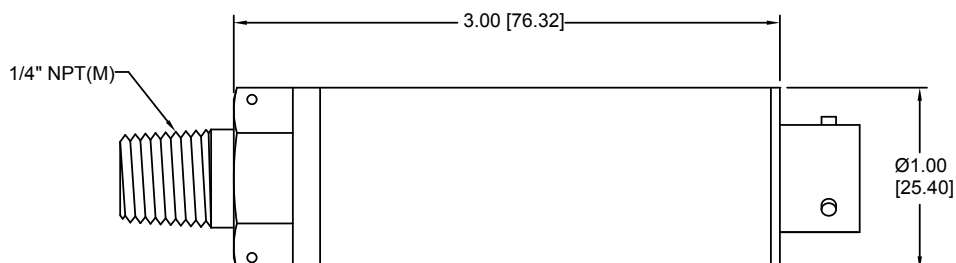

REFERENCE SPECIFICATIONS

ELECTRICAL	MECHANICAL
<ul style="list-style-type: none"> • Supply Voltage: 9.0 to 40 Vdc • Output Signal: 4-20 mA • Load Impedance: 1,350 Ω max. at 36 Vdc and 750 Ω max. Vdc • Zero Balance: $\pm 2\%$ FSO at 70 °F • Insulation Resistance: > 10 MΩ at 50 Vdc and 70 °F • Connection: 1/2" NPT (M) conduit with 36" cable leads or 6-pin Bendix connector 	<ul style="list-style-type: none"> • Process Connection: 1/2" NPT (M) • Proof Pressure: 5X FSO or 2K PSI (138 BAR), whichever is less • Burst Pressure: 7X FSO 3.5K PSI (242 BAR), whichever is less • Burst Pressure: 0-50 thru 0-500 PSI (3.5 thru 35 BAR) gauge, sealed gauge, absolute • Environmental: Design to meet IP67 (Some options may affect this. Consult factory if critical.)
MATERIALS OF CONSTRUCTION	TEMPERATURE
<ul style="list-style-type: none"> • Wetted Parts: Inconel 718 • Housing: 316 stainless steel 	<ul style="list-style-type: none"> • Compensated: 0 °F to +180 °F (-18 °C to +82 °C) • Operating Ambient: -20 °F to +190 °F (-29 °C to +88 °C) • Maximum Operating Process: +250 °F (+121 °C) • Effect on Zero/Span: $< \pm 2.0\%$ FSO/100 °F
STATIC ACCURACY (RSS) (HYSTERESIS, NON-LINEARITY & REPEATABILITY @ +70 °F)	
Standard: $\pm 0.5\%$ FSO Improved: $\pm 0.2\%$ FSO	

**Standard configurations shown.
Please consult factory for other options.**

All specifications are for reference purposes only. In the interests of continuous product improvement, all specifications are subject to change without notice. Please contact GP:50 for assistance with your application.

© 2015 GP:50 NY Ltd. | **U.K. Distributor Interface Force Measurements Ltd**

Tel: 01344 776666 **Fax:** 01344 774765 **Email:** Info@interface.uk.com **Web:** www.gp50.co.uk

